

ACCESSORIES

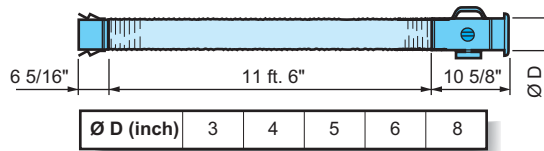

Material quick coupling & suction nozzle	Powder coated sheet steel
Hose material	PVC-coated polyamide fabric
Temp. Range	5°F - 200°F
Weight	6 - 11 lb

EXTENSION HOSE

FLS-75, -100, -125, -160 & -200

Extension hose with magnetic nozzle and quick coupling to the local extractor. This extends the working area and facilitates working inside or under objects. Also available with heat resistant hose. For other hose options, contact Enviroflex-Movex Inc.

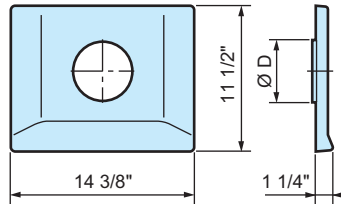

Hood	Ø D (inch)
100	4
125	5
160	6

Material	ABS-plastic
Temp. Range	5°F - 175°F
Weight	12 oz

FLAT SCREEN HOOD

PH 350-100, -125 & -160

The flat screen hood is designed to maximize the capture radius and working area without impeding the view of the operator.

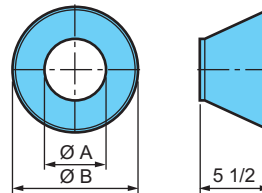

Hood	Ø A (inch)	Ø B (inch)
75	3	10
100	4	10
125	5	10
160	6	12
200	8	14

Material	Powder coated aluminum
Temp. Range	5°F - 390°F
Weight	14 oz

CONICAL HOOD

KH 075, -100, -125, -160 & -200

With halogen light: KHB 075, -100, -125, -160 & -200

The conical hood is used for work in hazardous environments, since it captures hot fumes, grinding dust etc. The hood may be equipped with a 12V, 20 or 50W halogen light with a 120V to 12V step-down transformer.

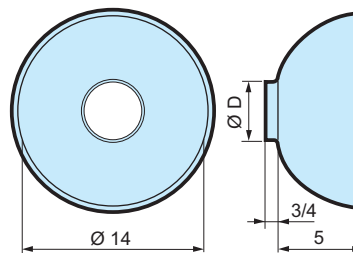

Hood	Ø D (mm)
100	4
125	5
160	6

Material	PMMA(HIP) transparent
Temp. Range	5°F - 175°F
Weight	12 oz

DOME HOOD

K 350-100, -125 & -160

The dome hood is designed to maximize the capture radius without impeding the view of the operator.

Movex also offers a range of fans and automatic control devices for our local extractors

MOVEX[®]
LOCAL EXTRACTOR
Pure advantage

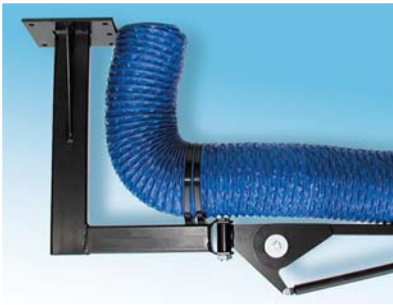

CEILING BRACKET
 TIX-500, -1000 & -1500
 Adapted to ceiling mounting of R, RX
 and TEX extractors.
 The ceiling bracket may also be used for
 floor mounting after adaptation.

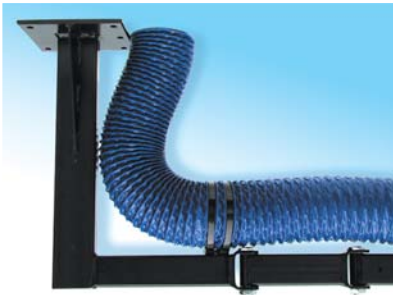
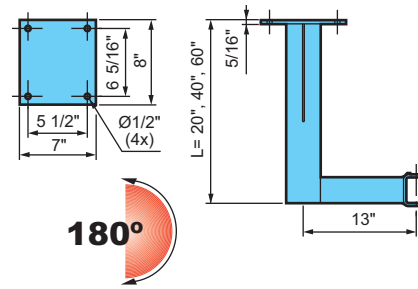

CEILING BRACKET
 TIX 180 180-500, -1000 & -1500
 Adapted to ceiling mounting of R, RX and
 TEX extractors. An additional link facilitates
 180 degree flexibility left & right.
 The ceiling bracket may also be used for
 floor mounting after adaptation.

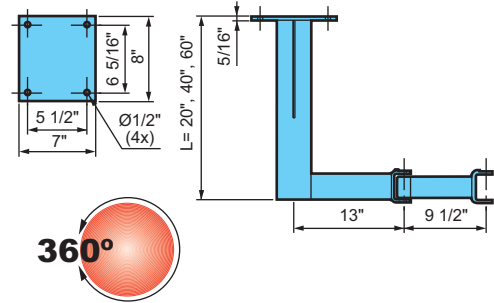

CEILING BRACKET
 TIS-500, -1000 & -1500
 Adapted to ceiling mounting of R, RX
 and TEX extractors with 360 degree
 swivel rotation.
 The ceiling bracket may also be used for
 floor mounting after adaptation. Max.
 extractor length: 10 feet.

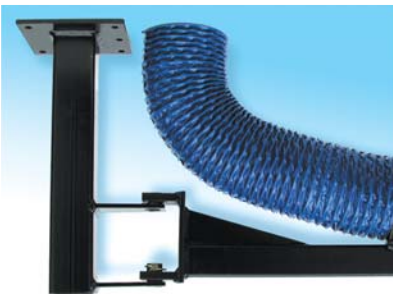
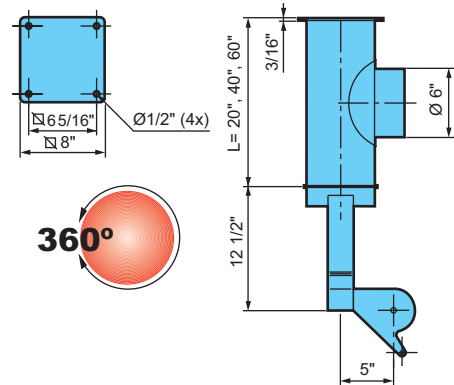

CEILING BRACKET
 TIZ-500, -1000 & -1500
 Adapted to ceiling mounting of RZ and
 RZX extractors up to 22 feet long.
 The ceiling bracket may also be used for
 floor mounting after adaptation.

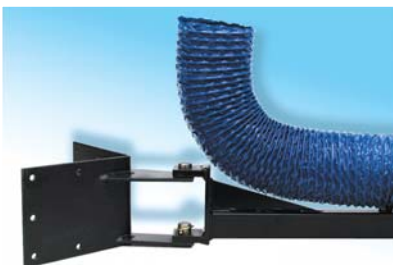
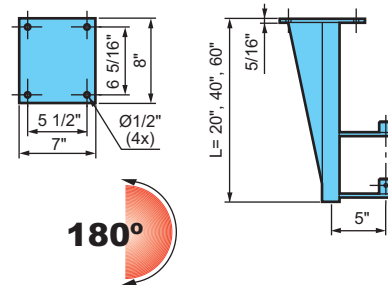

COLUMN BRACKET
 VIZ-1
 Adapted to column mounting of RZ and
 RZX 4500 and 6500. Facilitates 270 degree
 turning radius.

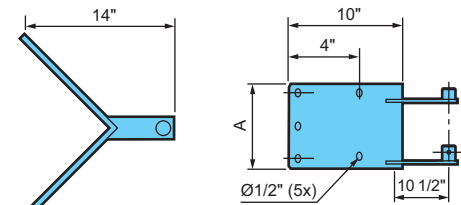

COLUMN BRACKET
 VIZ-2

See above. Adapted to RZX 8500.



	A (inch)
VIZ-1	8
VIZ-2	16

Dealer: _____